



TRANSFER OIL

Pure Fluid Attitude



Female NPT | Torpedo MP

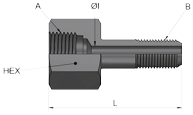

Part no.	Description	Side A	Side B	ID	HEX	L	MAWP
D9DFC 02MS04 01	1/8 F-NPT M-MP* 1/4 15k 316D	1/8	1/4	2.8	5/8 16	43	15k
D9DFC 02MS06 01	1/8 F-NPT M-MP* 3/8 15k 316D	1/8	3/8	5.2	5/8 16	49	15k
D9DFC 02MS09 01	1/8 F-NPT M-MP* 9/16 15k 316D	1/8	9/16	6	3/4 19	55	15k
D9DFC 02MS12 01	1/8 F-NPT M-MP* 3/4 15k 316D	1/8	3/4	6	7/8 22	63	15k
D9DFC 02MS16 01	1/8 F-NPT M-MP* 1 15k 316D	1/8	1.00	6	1+3/16 30	80	15k
D9DFC 04MS0 401	1/4 F-NPT M-MP* 1/4 15k 316D	1/4	1/4	2.8	3/4 19	46	15k
D9DFC 04MS06 01	1/4 F-NPT M-MP* 3/8 15k 316D	1/4	3/8	5.2	3/4 19	52	15k
D9DFC 04MS09 01	1/4 F-NPT M-MP* 9/16 15k 316D	1/4	9/16	8	3/4 19	58	15k
D9DFC 04MS12 01	1/4 F-NPT M-MP* 3/4 15k 316D	1/4	3/4	8	7/8 22	66	15k
D9DFC 04MS16 01	1/4 F-NPT M-MP* 1 15k 316D	1/4	1.00	8	1+3/16 30	82	15k
D9DFC 06MS04 01	3/8 F-NPT M-MP* 1/4 15k 316D	3/8	1/4	2.8	1 26	49	15k
D9DFC 06MS06 01	3/8 F-NPT M-MP* 3/8 15k 316D	3/8	3/8	5.2	1 26	55	15k
D9DFC 06MS09 01	3/8 F-NPT M-MP* 9/16 15k 316D	3/8	9/16	8	1 26	61	15k
D9DFC 06MS12 01	3/8 F-NPT M-MP* 3/4 15k 316D	3/8	3/4	11	1 26	69	15k
D9DFC 06MS16 01	3/8 F-NPT M-MP* 1 15k 316D	3/8	1.00	12	1+3/16 30	85	15k
D9DFC 08MS0 401	1/2 F-NPT M-MP* 1/4 15k 316D	1/2	1/4	2.8	1+3/16 30	54	15k
D9DFC 08MS06 01	1/2 F-NPT M-MP* 3/8 15k 316D	1/2	3/8	5.2	1+3/16 30	60	15k
D9DFC 08MS09 01	1/2 F-NPT M-MP* 9/16 15k 316D	1/2	9/16	8	1+3/16 30	66	15k
D9DFC 08MS12 01	1/2 F-NPT M-MP* 3/4 15k 316D	1/2	3/4	11	1+3/16 30	74	15k
D9DFC 08MS16 01	1/2 F-NPT M-MP* 1 15k 316D	1/2	1.00	14	1+3/16 30	90	15k
D9CFC1 2MS040 1	3/4 F-NPT M-MP* 1/4 10k 316D	3/4	1/4	2.8	1+3/8 35	54	10k
D9CFC1 2MS060 1	3/4 F-NPT M-MP* 3/8 10k 316D	3/4	3/8	5.2	1+3/8 35	60	10k
D9CFC1 2MS090 1	3/4 F-NPT M-MP* 9/16 10k 316D	3/4	9/16	8	1+3/8 35	66	10k
D9CFC1 2MS1201	3/4 F-NPT M-MP* 3/4 10k 316D	3/4	3/4	11	1+3/8 35	74	10k
D9CFC1 2MS1601	3/4 F-NPT M-MP* 1 10k 316D	3/4	1.00	14	1+3/8 35	90	10k
D9CFC1 6MS060 1	1 F-NPT M-MP* 3/8 10k 316D	1.00	3/8	5.2	1+3/4 45	66	10k

D9CFC1 6MS090 1	1 F-NPT M-MP* 9/16 10k 316D	1.00	9/16	8	1+3/4 45	72	10k
D9CFC1 6MS1201	1 F-NPT M-MP* 3/4 10k 316D	1.00	3/4	11	1+3/4 45	80	10k
D9CFC1 6MS1601	1 F-NPT M-MP* 1 10k 316D	1.00	1.00	14	1+3/4 45	96	10k

*Dimensions and values shown may be changed without prior notice to improve product performances and reliability.
Transfer Oil S.p.A. assumes no liability on mistakes nor errors appearing in this spec sheet.
Document date: 13/05/2026
www.transferoil.com*